

# Electric towing tractor 1.5 ton

## **Simai**

*Three wheel-series*

TTE15

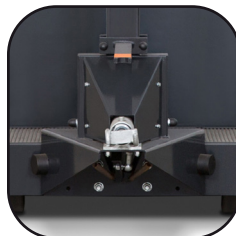

# Electric towing tractor 1.5 ton

Truck specifications					TTE15
Identification	1.1	Manufacturer			Simai S.p.A
	1.2	Model			TTE15
	1.3	Drive			Electric
	1.4	Operator type			Standing driver
	1.5.1	Towing capacity	Q	kg	1500
	1.7	Rated drawbar pull	F	N	750
	1.9	Wheelbase	y	mm	648
Weight	2.1	Service weight		kg	526
	2.2	Axle load, with load, front/rear		kg	292 / 314
	2.3	Axle load, without load, front/rear		kg	292 / 234
Wheels	3.1	Tyre - Cushion(Cu), Extra-elastic(SE), Pneumatic(Pn),Polyurethane			SE
	3.2	Wheel size, front			Ø 300x85
	3.3	Wheel size, rear			Ø 160x50
	3.5	Wheels, number front/rear (x = driven wheels)			1x/4
	3.6	Track width, front	b <sub>10</sub>	mm	—
	3.7	Track width, rear	b <sub>11</sub>	mm	600
Dimensions	4.7	Height of cab	h <sub>6</sub>	mm	—
	4.8	Seat height	h <sub>7</sub>	mm	—
	4.8.1	Step on platform height		mm	195
	4.12	Coupling height	h <sub>10</sub>	mm	125 - 180 - 235 - 345
	4.13	Loading height, unloaded	h <sub>11</sub>	mm	—
	4.16	Length of loading surface	l <sub>3</sub>	mm	—
	4.17	Overhang	l <sub>5</sub>	mm	402
	4.18	Width of loading surface	b <sub>9</sub>	mm	—
	4.19	Overall length	l <sub>1</sub>	mm	1275
	4.21	Overall width	b <sub>1</sub>	mm	750
	4.32	Ground clearance, centre of wheelbase	m <sub>2</sub>	mm	70
	4.35	Turning radius front	W <sub>a</sub>	mm	990
	4.35.1	Turning radius rear		mm	710
	4.36	Internal turning radius	b <sub>13</sub>	mm	303
4.36.1	Aisle width when turning 90°		mm	1050	
Performance data	5.1	Travel speed, with/without load		km/h	9
	5.6	Max. drawbar pull		N	1600
	5.7	Gradeability		%	3 / 15
	5.8	Max. gradeability loaded/unloaded		%	3 / 15
	5.10	Service / parking brake (I=Hydraulic E=Electromagnetic M=Mechanical)			E / E
	5.10.1	Type of service brake front/rear			Electromagnetic / —
Electric motor	6.1	Drive motor rating S2 60 min		kW	2,3
	6.3	Battery according to DIN 43531 / 35 / 36 A, B, C, no			no
	6.4	Battery voltage, nominal capacity	K <sub>5</sub>	V/Ah	24/375
	6.5	Battery weight		kg	310
	6.6	Energy consumption according to EN 16796		kWh/h	0,66
	Others	8.1	Electronics control		
8.4		Sound level at driver's ear according to EN 12053		dB(A)	69

As per VDI guidelines 2198, this datasheet applies to standard electric tractor / platform truck only. Dimensions are not binding and can be changed in any moment. The performances must be intended for brand new machines, after having completed the running-in tested in San Donato Milanese factory in normal climatic conditions. Performances and weight are to be intended with standard motors and battery and with pneumatic tires. Some data can vary according to different equipments.

## Towed weight

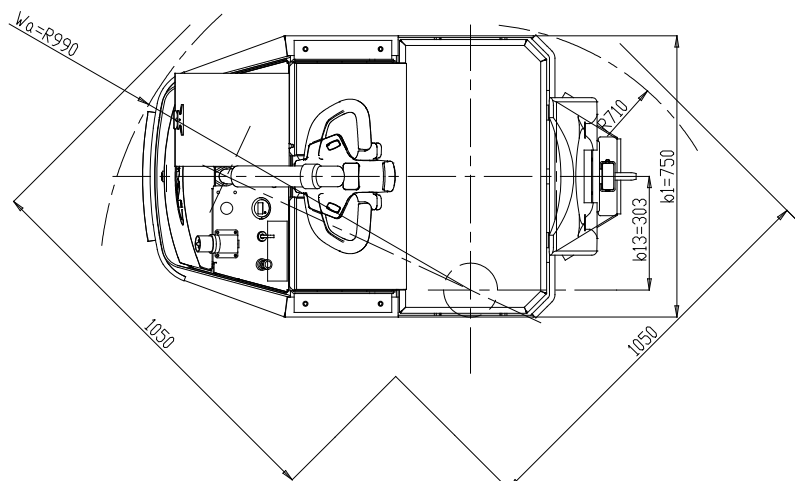
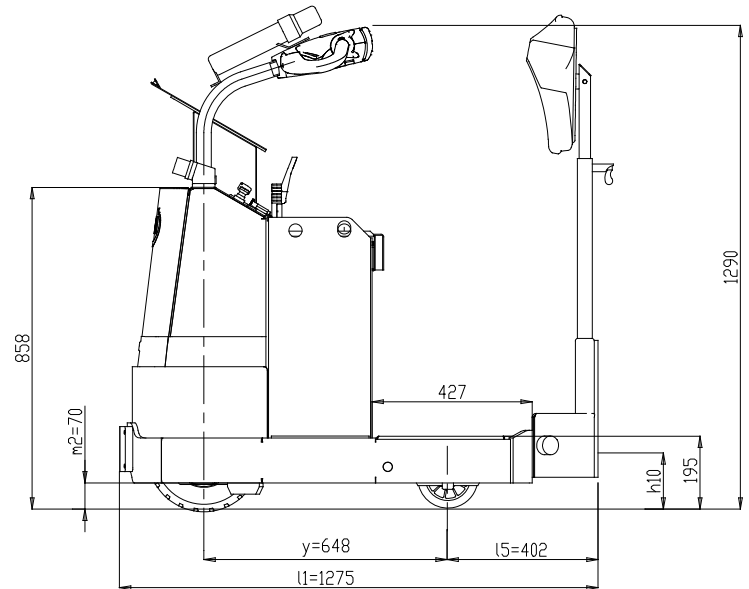
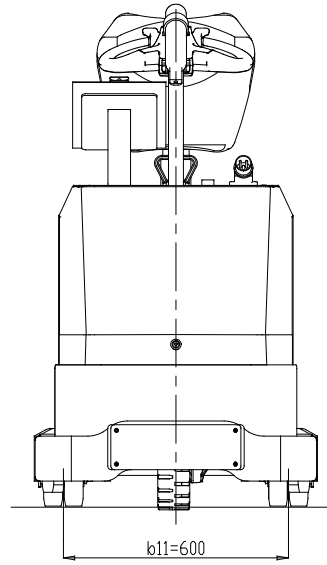
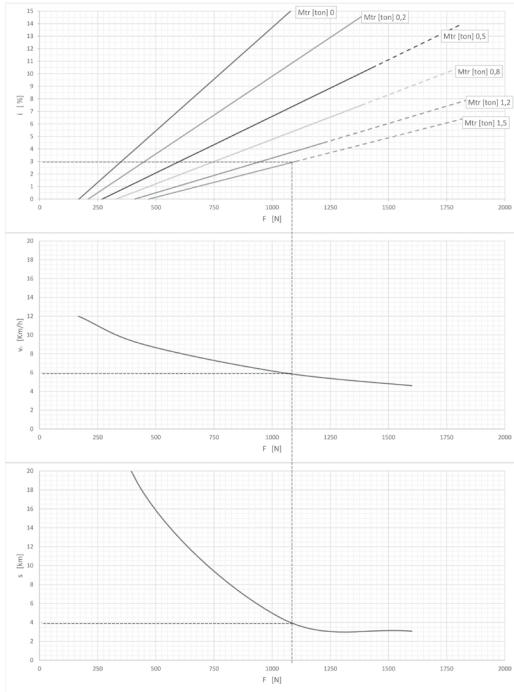

TTE15 FEATURE CURVES



## Standard equipments:

- AC power system with electronic speed control
- Operator presence system
- Pneumatic tyres
- Regenerative braking
- Mechanical steering
- Automatic parking brake
- Multifunction digital display
- On board battery charger

### **GABELSTAPLER CENTER KAMEN**

 02307 - 208150      Gabelstapler-Center Kamen  
 info@gabelstapler-center.de      GmbH & Co. KG  
 www.gabelstapler-center.de      An der Seseke 30  
59174 Kamen

TMHE-Toyota Material Handling Europe — version 2, 2023-03-10

**TOYOTA**

MATERIAL HANDLING